

Check for signs of Sudden Cardiac Arrest: Unresponsive
 Not Breathing Normally

1.PULL

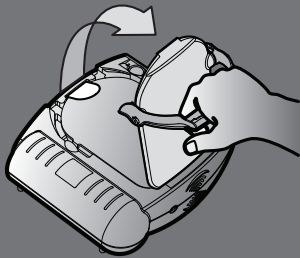

2.PLACE

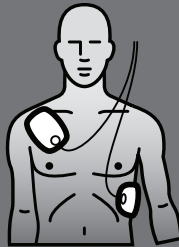

3.PRESS

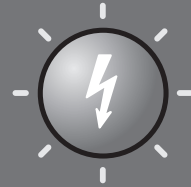

QUICK REFERENCE GUIDE



QUICK REFERENCE

Detailed Instructions

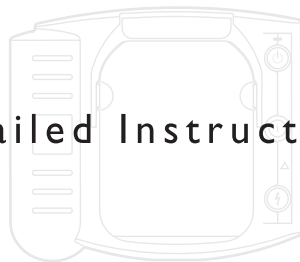

To start: Pull handle. Remove protective cover.

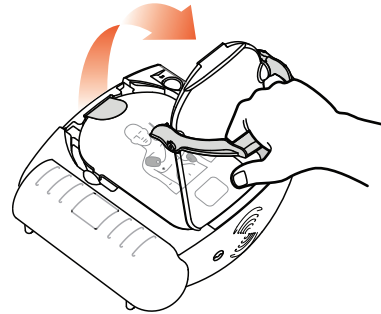
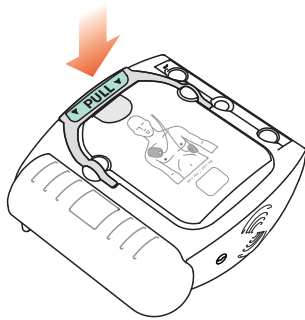

Remove all clothes from victim's chest.
Clean and dry skin, if needed.

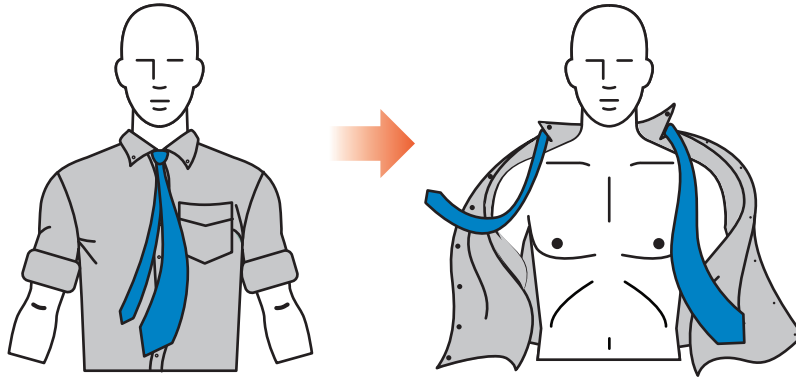

2

Peel off film seal and remove pads.

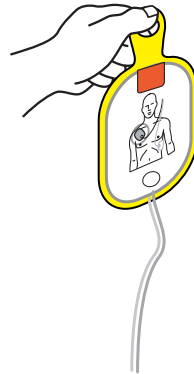
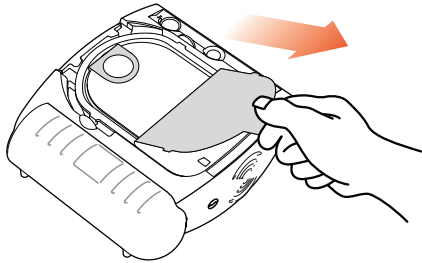

Peel each pad from yellow plastic liner.

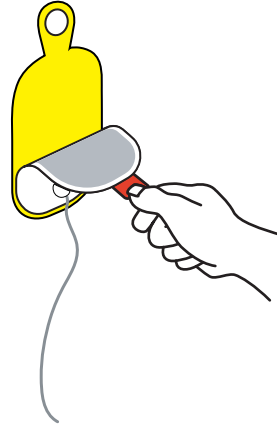
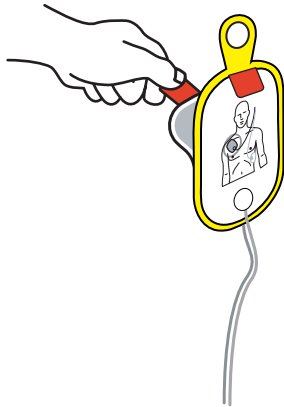

Place pads exactly as shown in the picture.

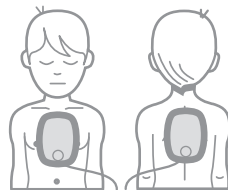
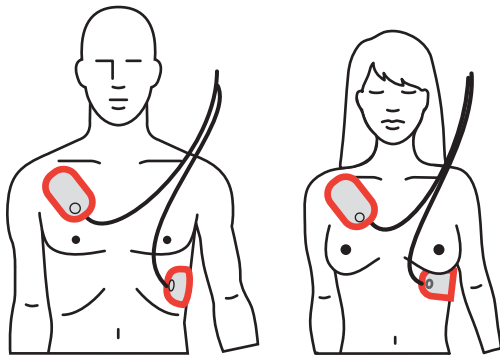

(0-8 YEARS) < 55 lbs / 25 kg

Analyzing ... Do not touch the patient!

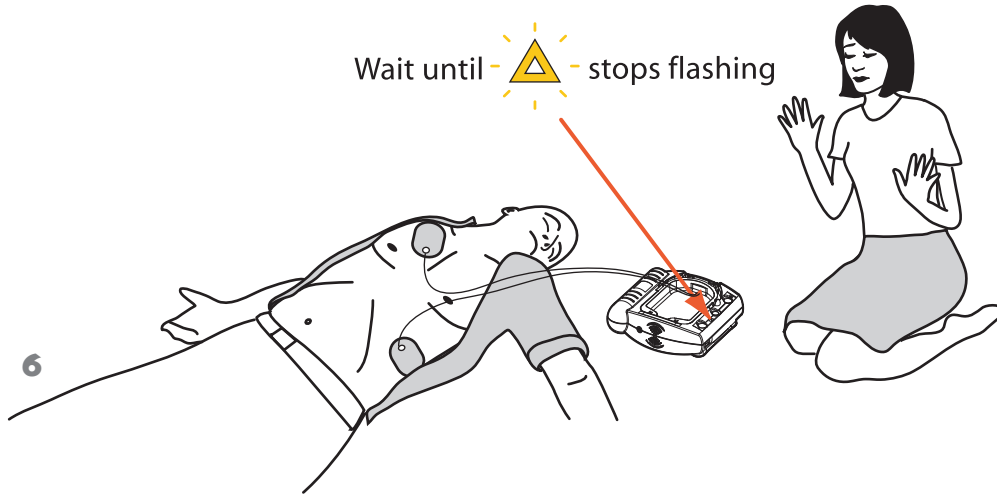

To shock: Press flashing orange shock button.
Do not touch patient.

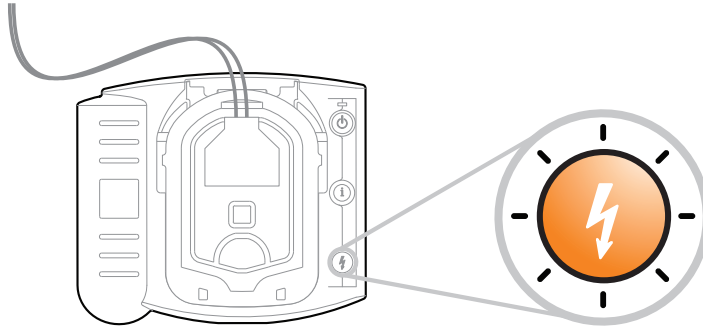

To get help with CPR: Press flashing blue button.

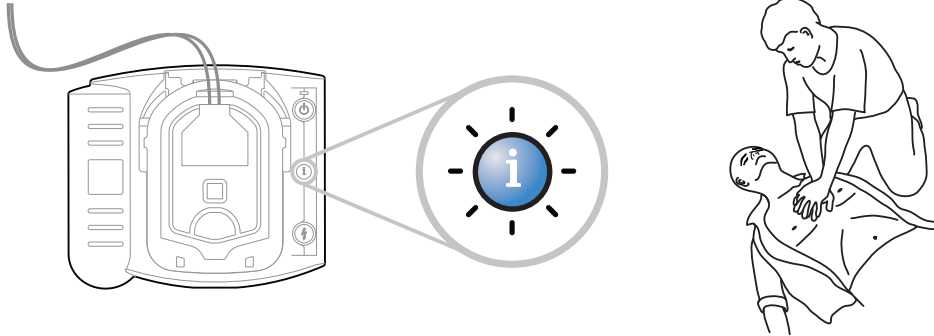

8

Pinch nose, tilt head • 30 compressions • 2 full breaths

If cartridge needs to be replaced: Slide latch.

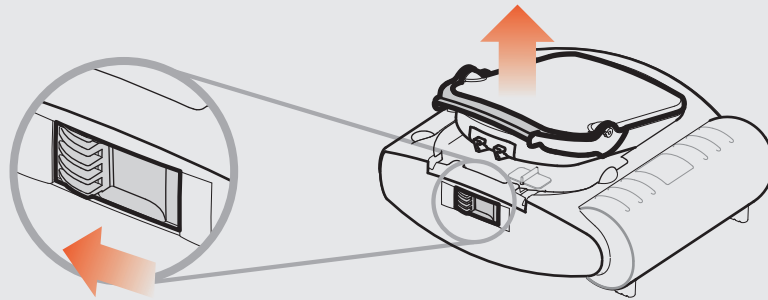

Printed in USA

Philips Medical Systems
Seattle, WA 98121

Copyright © 2006
Philips Electronics North American Corp

M 5 0 6 6 - 9 7 8 0 0



0 1 1 8 3 4 - 0 0 0 6

PHILIPS